

B-Series Industrial Grade for Professional Use

For 1/4", 3/8" and 1/2" Hose I.D.

B-Series all steel hose reels are designed for industrial applications where heavy usage also needs a small footprint to accommodate. Built on a smaller scale with the same components as our workhorse C series reels, this reel's compact design fits easily into restricted space areas. Heavy gauge base with no welds or bolts, this product will give years of dependable service in high use applications. With a carbon steel outlet swivel and fluid shaft, the reels are available for use in low pressure (300psi), medium pressure (2,000psi) and high pressure (5000psi) applications for air, water, oil, and grease.

This product is ideal where hose storage and operating efficiency are needed. Full flow 1/2" shaft allows maximum delivery to the application point. Four position guide arm allows easy adjustment to the position best suited.

Product Name:

Hosetract B-Series Low/Medium/High Pressure

Manufacturer:

Hosetract Industries Inc.
 6433 Discount Drive
 Fort Wayne, IN 46818
 www.hosetract.com

Swivel:

Standard: Carbon Steel zinc coated

Features:

- Powder Coat finish
- Mounting Slots - 3/8" wide x 3/4" deep for max 5/16" dia. bolt
- Safety banded spring sealed springcase
- Full 1/2" flow path (Low and Medium pressure models)
- Compact design
- Reels shipped standard front hose payout position.
- Nonsparking latch mechanism



**Inlet - 1/4" FPT (All HB)
 - 1/2" FPT (All LB, MB)**

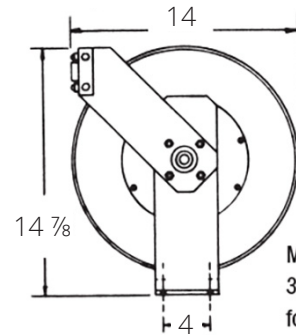
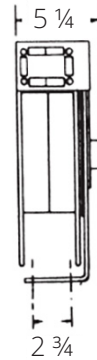

Mounting Slots
 3/8" wide x 3/4" deep
 for max 5/16" dia. bolt

**Standard front
 payout position**

ACCESSORIES:



1234A - 1/4"



1233A - 3/8"



1232A - 1/2"

Hose Stop Assemblies



Mount Assemblies

1279A - I-Beam Bracket



1282A - Swivel Bracket

B-Series Industrial Grade for Professional Use

For 1/4", 3/8" and 1/2" Hose I.D.

B SERIES

Models without hose and hose stop

Model #	Weight	PSI	Hose Capacity ID	Hose Capacity ft	Reel Inlet	Reel Outlet
LB-200	25	1000	1/4"	50'	1/2" NPT (F)	3/8" NPT (F)
LB-300	25	1000	3/8"	35'	1/2" NPT (F)	1/2" NPT (F)
LB-500	25	1000	1/2"	25'	1/2" NPT (F)	1/2" NPT (F)
MB-300	22	4000	3/8"	35'	1/2" NPT (F)	1/2" NPT (F)
MB-500	23	4000	1/2"	25'	1/2" NPT (F)	1/2" NPT (F)
HB-200	25	5000	1/4"	35'	1/4" NPT (F)	1/4" NPT (F)
HB-300	25	5000	3/8"	25'	1/4" NPT (F)	3/8" NPT (F)

Models with hose and hose stop

Model #	Weight	PSI	Hose ID	Hose Length ft	Reel Inlet	Hose End Fitting	
Air/Water AW		Low Pressure					
LB-250	29	300	1/4"	50'	1/2" NPT (F)	1/4" NPT (M) *	
LB-335	32	300	3/8"	35'	1/2" NPT (F)	1/4" NPT (M) *	
LB-525	32	300	1/2"	25'	1/2" NPT (F)	1/2" NPT (M) *	
Lubricants LU		Medium Pressure					
MB-335	31	3000	3/8"	35'	1/2" NPT (F)	3/8" NPT (M) *	
MB-525	31	2750	1/2"	25'	1/2" NPT (F)	1/2" NPT (M) *	
Grease GR		High Pressure					
HB-235	33	5000	1/4"	35'	1/4" NPT (F)	1/4" NPT (M) *	
HB-325	34	5000	3/8"	25'	1/4" NPT (F)	3/8" NPT (M) *	

* Can be furnished with different sizes upon request.